

EDUCATION BULLETIN

SPRING
2012



ESTIMATING & PROJECT MANAGEMENT CERTIFICATE PROGRAM

gbca

PLEASE NOTE

**CLASSES WILL BE RUN
PROVIDED MINIMUM
ATTENDANCE
REQUIREMENTS ARE
MET.**

**DIRECTIONS TO THE MONTGOMERY COUNTY FIRE
ACADEMY**

**1175 CONSHOHOCKEN ROAD
CONSHOHOCKEN, PA 19428-1028
(610) 278-3500**

Located between Ridge Pike and the Schuylkill River

FROM 76 East or West – Take the Conshohocken exit (#29) to Fayette Street. Go across the Matsonford Bridge to the first traffic light at West Elm Street and turn left. As you pass Lukens Steel the road becomes Conshohocken Road. After 1.8 miles from the traffic light, you will come to flashing Lights at the crest of the hill. Turn right and follow chain link fence to the entrance to the parking lot.

FROM 476 North – Take Exit 7 – Norristown. At the end of the exit, bear to the right. As you are approaching the first intersection, which is Ridge Pike, yield to the right and get on to Ridge Pike. At the fourth light, make a left turn on to Conshohocken Road. Watch for the blinking light at the Crest of the hill, 8/10 mile, and watch for the opposing traffic, as you turn left to the Fire Academy Driveway.

FROM 476 South – Take Exit 7 - Norristown. The exit will put you on Ridge Pike, headed for Norristown. At the fourth light, turn left onto Conshohocken Road and proceed as for 476 North.

FROM THE PA TURNPIKE - Take the Mid-County Exit – 25A to 476 South to Exit 7 – Norristown. Proceed as above.

**ESTIMATING & PROJECT MANAGEMENT
CERTIFICATE PROGRAM**

B001 - BLUE PRINT READING

Course Description: The goal of this course is to have the student become able to interpret building working drawings. Topics considered will include: Standard Drawing Forms, Drafting Systems, Orthographic Projection, Sections, Elevations, Details, Schedules, Dimensions, Reproduction of Drawings, Revisions, and the relationship of the drawings to other construction documents. Students will be tested in their knowledge of reading drawings.

NOTE: **Mechanical/Electrical Blueprint Reading will not be covered.**

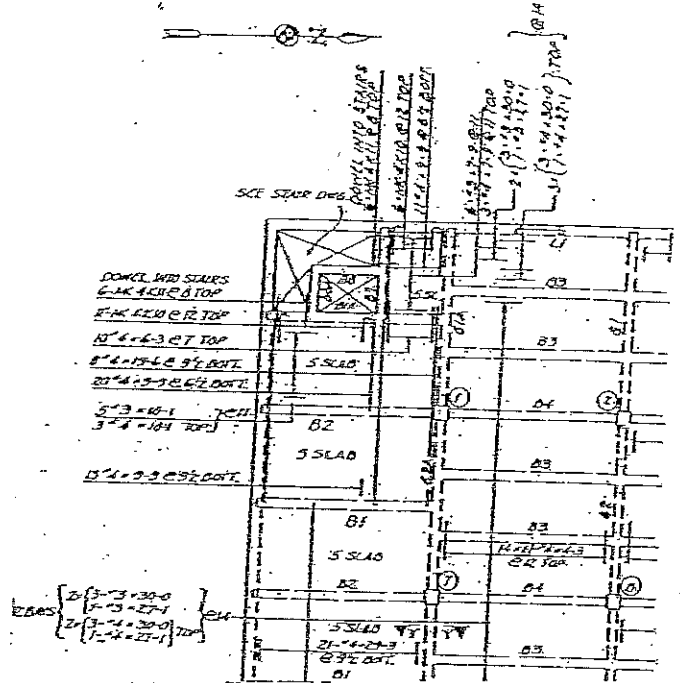

Certificate

Credits: 3.0 CEU

Prerequisite: None

Instructor: Ronald Trawinski

Class Meetings: 6:00 - 9:00 p.m. Ten Monday evenings from January 23 through March 26 at MCFA.

Registration: Before January 16, 2012 by calling GBCA at (215) 568-7015.

Tuition Cost: \$250 (free to employees of GBCA member firms or employees of basic trade IAP contributors).

Text Book: **“Understanding Construction Drawings” Published by: DELMAR THOMSON LEARNING, written by Mark Huth & Walter Wells.**

The textbook will be provided free of charge.

For further information, contact Michael Magee or Joann Piazza at (215) 568-7015.

**GBCA/ASPE
ESTIMATING & PROJECT MANAGEMENT
CERTIFICATE PROGRAM**

SPRING, 2012

E001 - GENERAL ESTIMATING PRINCIPLES

Course Description: The goal of this course is to familiarize the participant with the methods utilized in preparing the estimate for building construction. The principles utilized can be applied to estimates for all building construction disciplines from general construction to electrical work. Attention will be directed to proper methods for material take-off, production rates of work, teams, equipment requirements, and determination of overhead. During the course, the participants will prepare sample estimates.

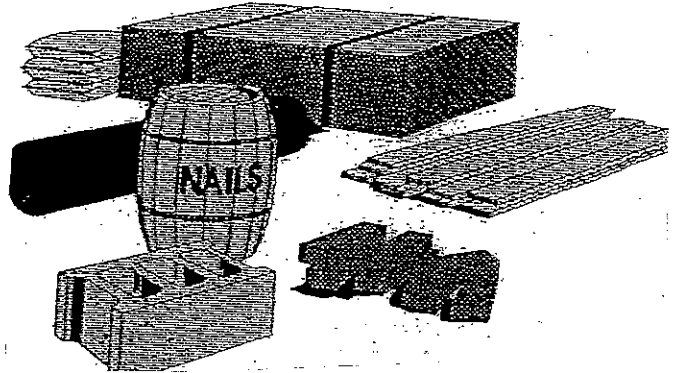

Certificate Credits:	3.0 CEU
Prerequisite:	None
Instructor:	Terrence McGeehan
Class Meetings:	6:00 - 9:00 p.m. Ten Tuesday evenings from January 24 through March 27, 2012 at MCFA.
Registration:	Before January 16, 2012 by calling GBCA at (215) 568-7015.
Tuition Cost:	\$250 (free to employees of GBCA member firms or employees of basic trade IAP contributors).
Text Book:	None

For further information, contact Michael Magee or Joann Piazza at (215) 568-7015.

**ESTIMATING & PROJECT MANAGEMENT
CERTIFICATE PROGRAM**

E005 – PRECONSTRUCTION MANAGEMENT

Course Description: This course will examine the role of the lead estimator/project manager in managing a project from inception through mobilization. Topics include estimating, scheduling, value analysis, the preconstruction process, project communication, the contract documents, purchasing, subcontracting and constructability reviews. Class participation will be encouraged through open discussion on weekly topics. This class is recommended for anyone who desires a better understanding of what transpires before actual construction on a project proceeds in the field.



- Certificate Credits: 3.0 CEU
- Prerequisite: None
- Instructor: Donald Logan, CPE
- Class Meetings: 6:00 - 9:00 p.m. Ten Wednesday evenings from January 25 through March 28 at MCFA.
- Registration: Before January 16, 2012 by calling GBCA at (215) 568-7015.
- Tuition Cost: \$250 (free to employees of GBCA member firms Or employees of basic trade IAP contributors).
- Text Book: None

For further information, contact Michael Magee or Joann Piazza at (215) 568-7015.

REGISTRATION FORM GBCA CONSTRUCTION	Complete all information and return to: GENERAL BUILDING CONTRACTORS ASSOCIATION
EDUCATION COURSES – SPRING, 2012 <i>(This form may be duplicated)</i>	36 South 18th Street, P.O. Box 15959, Philadelphia, PA 19103 Phone: (215) 568-7015 Fax: (215) 568-3115 E-MAIL jpiazza@gbca.com

PLEASE PRINT

Course #1 _____ Course Title _____ School _____

Course #2 _____ Course Title _____ School _____

Name _____ Social Security # _____

Address _____ Date Of Birth _____

City _____ State _____ Zip _____ Phone # _____

E-Mail Address Required

Position/Job Title _____

Current Employer _____ Address _____ Last Date of Employment _____

City _____ State _____ Zip _____ Phone# (very important) _____

Previous Employer _____ City _____ State _____ Zip _____ Phone# _____ Last Date of Employment _____

** By signing this registration form you will have authorized GBCA to obtain an official copy of your grades at the end of the semester.